

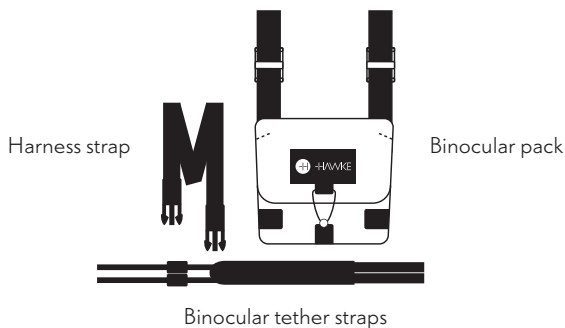

BINOCULAR HARNESS PACK

THE KIT



OPERATING INSTRUCTIONS

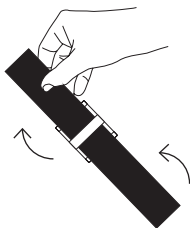

01 | Remove the harness strap and binocular tether straps from the case (harness strap is attached to the back). Then thread the wide end of the binocular tether straps through the harness strap buckles.



BINOCULAR HARNESS PACK

OPERATING INSTRUCTIONS Cont.

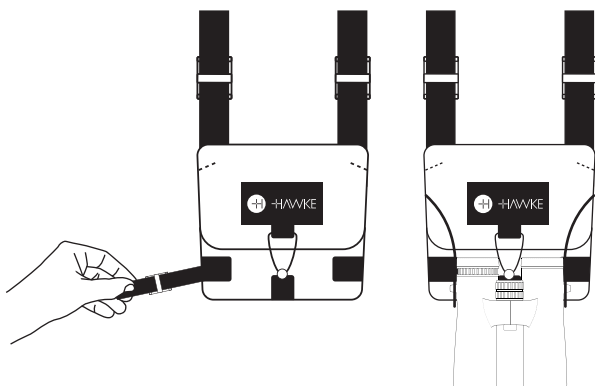

02 | Size to fit by adjusting the harness strap.

03 | Thread the binocular tether straps through the strap attachment on the binoculars and thread the binocular tether straps back through the tether strap buckles to secure.

The side of the pack is equipped with the MOLLE system for additional attachments.

www.hawkeoptics.com

 Born in the UK